

Limit Switch box, Type ITS100, Mechanical



SPECIFICATIONS

Enclosure	Weatherproof IP67, O-ring sealed
Material	Aluminum, Polyester coated
Ambient temperature	-20°C~+80°C
Switch cams	Adjustable, preset for 90°
Cable entries	2xM20x1.5
Terminal block	8 pos of terminal strips (6 for switches, 2 for solenoid valve power)
Position indicator	Dome type 0°~90°
Mounting bracket	Stainless steel acc. to VDI/VDE3845, NAMUR
Mechanical switches	2 pcs. Max 250V AC 16A, 125 V DC 0.6A

DIMENSIONS (mm)

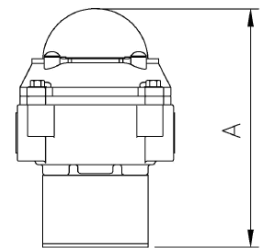
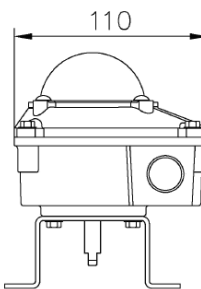
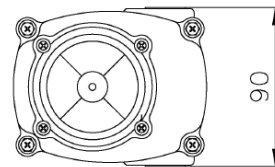

WIRING

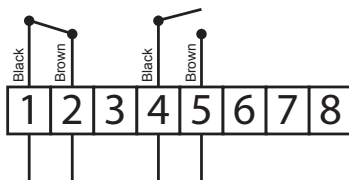

- 1 - IND. COMMON
- 2 - IND. CLOSED VALVE
- 3 - FREE
- 4 - IND. COMMON
- 5 - IND. OPEN VALVE
- 6 - FREE
- 7 - FREE
- 8 - FREE

A	C	E	S
136	2-35	8-20	3-10
146	55	35-150	-
166	250-400	-	-